

Image 1

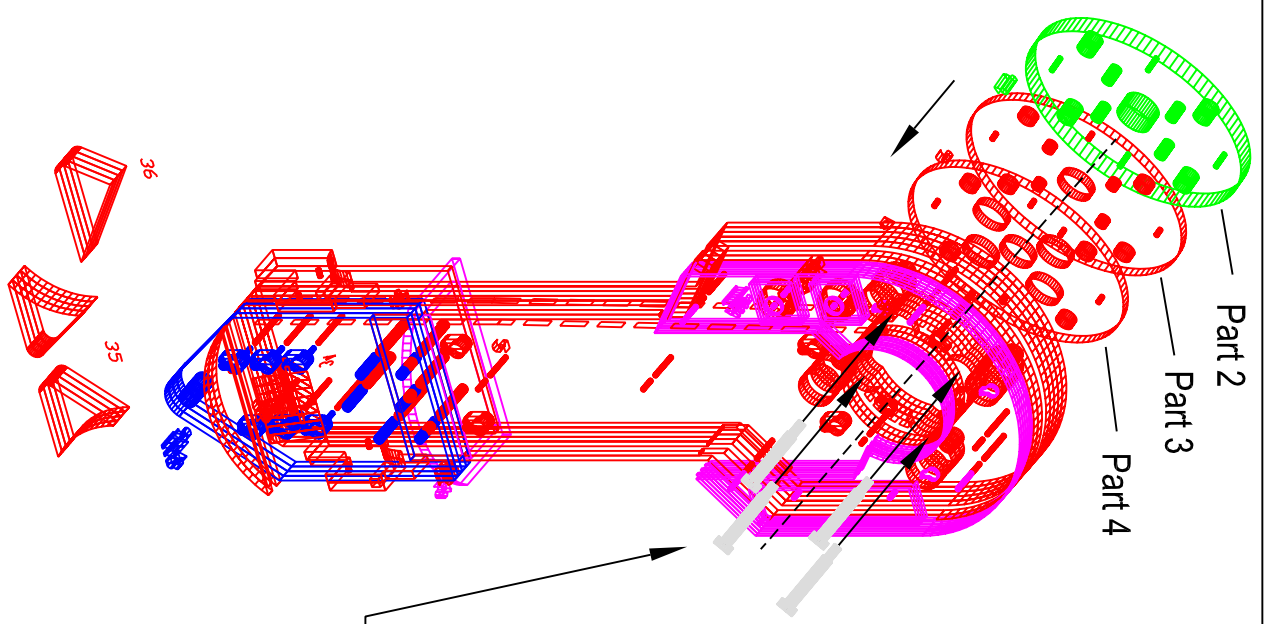

Image 2

- In Image 1 are the various extra items we have included with the leg kit
1. Buttons
  2. Ankle Details
  3. Cylinder holder
  4. Cylinder wedge
  5. Ankle stops

Image 2 is most of the parts installed.

The Hubs (Parts 2,3,4) are screwed to the back of the legs. Use Parts 2,3,4 as needed as not everyone needs all 3 parts depending on their frame.

Attach the legs to the frame using 4, Hex Socket Shoulder Screws 1/2" diameter shoulder x 2" long, 3/8-16UNC Thread x 5/8" Long through the hubs.